

Swamp and Overflowed Lands  
Survey No. 192.

Township 2 South  
Range 8 East

Sections 21, 22, 27 and 28.

Fractional S.E.  $\frac{1}{4}$  Sec. 21; fractional  
S.W.  $\frac{1}{4}$  Sec. 22; fractional N.W.  $\frac{1}{4}$  Sec.  
27; and fractional East  $\frac{1}{2}$  Sec. 28.

Base and Meridian of Mount Diablo

Containing 128.70 Acres  
Surveyed December 2<sup>d</sup> 1862

for  
Marion Wilson

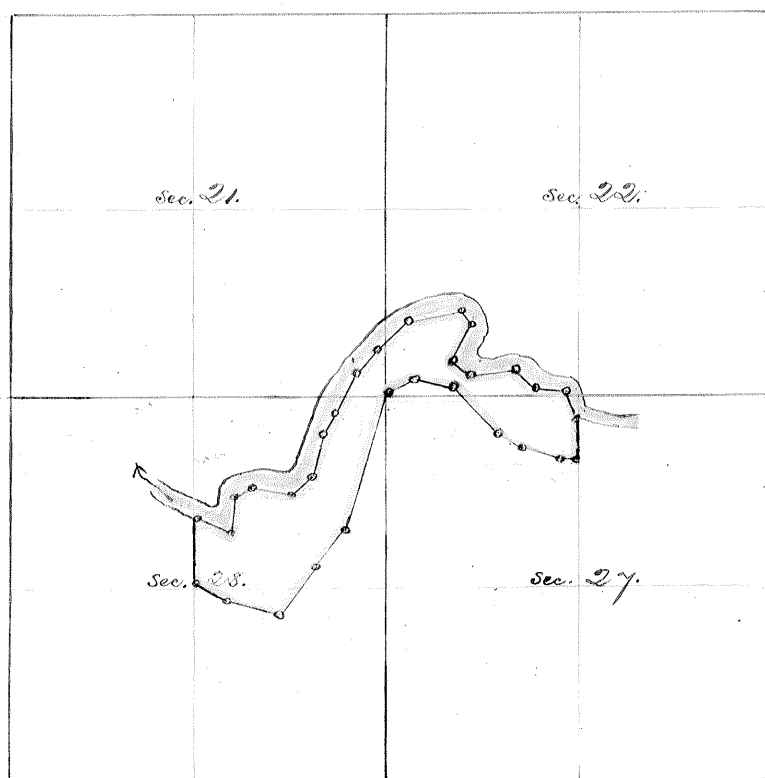

### Field Notes

Beginning at a Post set at the intersection of the  $\frac{1}{4}$  Section Line N.E.S. in Section 27, Sp. 2.S. R. 8.E. of Mt. Diablo Meridian, with the left Bank of the Stanislaus River; Thence South 2.50 chains to a forked Willow on line, 8.00 chains to a Post set at intersection with U.S. Meander Line, from which an Oak tree 2  $\frac{1}{2}$  feet diam. bears S 35° W. 97 links distant; Thence along said Meander Line, down Stream: - N 86° W 4.50 chs; N 70°  $\frac{1}{2}$  W 8.00 chs; N 56°  $\frac{1}{2}$  W 6.00 chs; N 38° W 10.00 chs; N 55° W 3.20 chs; N 77° W 8.50 chs; S 57°  $\frac{1}{4}$  W 7.00 chs; S 17° W 30.00 chs; S 42° W 10.00 chs; S 34° W 12.00 chs; N 74°  $\frac{3}{4}$  W 12.00 chs; N 60°  $\frac{1}{2}$  W 6.72 chs; to a Post set at intersection of the  $\frac{1}{4}$  Sec. line N.E.S. in Sec. 28; from which an Oak tree 3 ft. diam. bears N 48° W. 97 links dist. and another Oak 2 ft. diam. bears S 84°  $\frac{1}{2}$  W 1.52 chs. dist; Thence North 14.00 chs. to the left bank of said River; Thence up Stream; - S 67°  $\frac{1}{4}$  E 8.00 chs; N 9°  $\frac{1}{4}$  E 8.00 chs; N 60°  $\frac{1}{4}$  E 4.00 chs; S 74°  $\frac{1}{4}$  E 8.00 chs; N 18° E 9.00 chs; N 23°  $\frac{1}{2}$  E 5.00 chs; N 30°  $\frac{1}{4}$  E 10.00 chs; N 47°  $\frac{3}{4}$  E 6.00 chs; N 47°  $\frac{1}{4}$  E 9.00 chs; N 47°  $\frac{1}{2}$  E 6.00 chs; N 83°  $\frac{1}{4}$  E 12.00 chs; S 34°  $\frac{1}{4}$  E 4.00 chs; S 24°  $\frac{1}{4}$  W 9.00 chs; S 55°  $\frac{1}{2}$  E 5.50 chs; N 84°  $\frac{1}{4}$  E 9.00 chs; S 47° E 6.00 chs; N 86°  $\frac{1}{2}$  E 7.00 chs; S 5° E 5.26 chs; to point of beginning.

Run by the true Meridian: Magnetic Variation 15° 45' East.  
Surveyed in accordance with the Act of the Legislature concerning  
Swamp and Overflowed Lands, Approved April 18<sup>th</sup> 1859, and  
the instruction of the Surveyor General.

E. B. Beard  
Co. Surveyor Stanislaus Co.  
By A. J. Stakes  
Deputy

This Survey approved May 12<sup>th</sup> 1863

Approval recorded " 18. "

Witness H. H. Water