

88

MAP of the

DAYTON CEMETERY

Surveyed by M.C. Felt
May 1918
Scale 1" = 10'

State of California ss
County of Butte
President & Secretary of the Dayton Cemetery Association do hereby declare and say that we have caused the tract of land as delineated herein to be surveyed and plotted into lots for the purpose of abrogating the said 1855 by reference to and in accordance with this map. According to the 1881 Civil Code Cal.

W. C. Gault
Secretary

On this 24 day of July 1922 before me Myself, Justice, Notary Public in and for the County of Butte, State of California, personally appeared *H. H. Lounsbury* and *W. C. Gault* known to me to be the President and Secretary respectively of the corporation that executed the above instrument and they acknowledged to me that the said corporation executed the same in witness whereof, I have hereunto set my hand and affixed my official seal, this day and year first.

Myself, Justice
Notary Public in and for the County of Butte, State of California.

The Dayton Cemetery is situated in the N.E. 1/4 of Sec 20 T. 21 N. R. 1 E. M. D. M. W. C. Gault
County Surveyor
Butte Co. Cal.

7-88
88

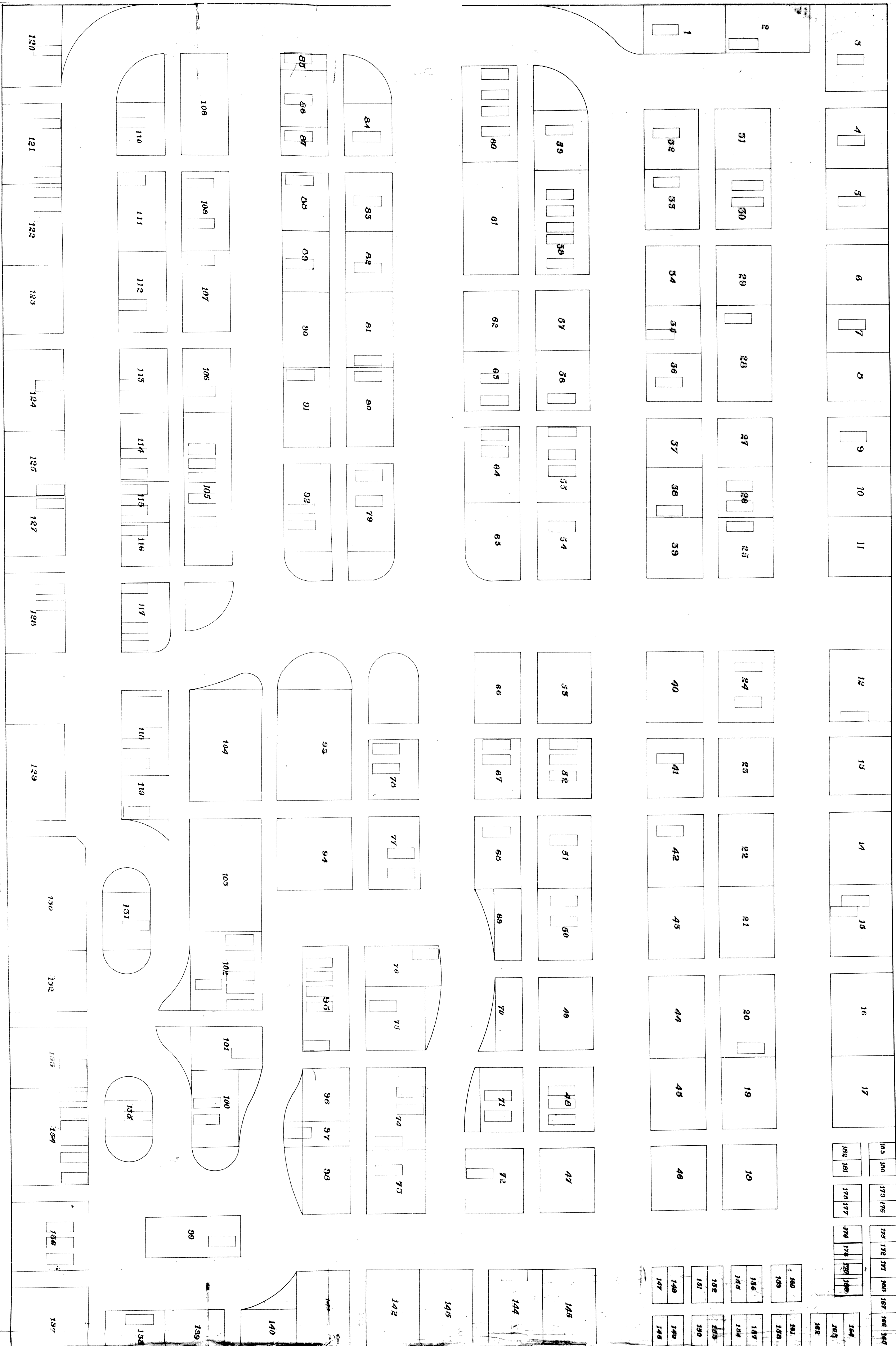

7-88

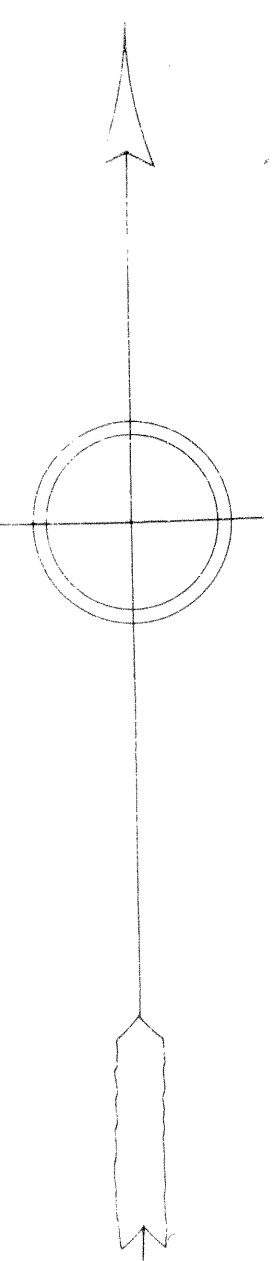

7-88

Filed for Record July 24, 1918.
W. C. Gault
County Surveyor
Butte Co. Cal.

7-88