

ASSESSMENT DIAGRAM INDEX MAP

T.4S., R.29E. M.D.M.
MONO COUNTY, CALIFORNIA

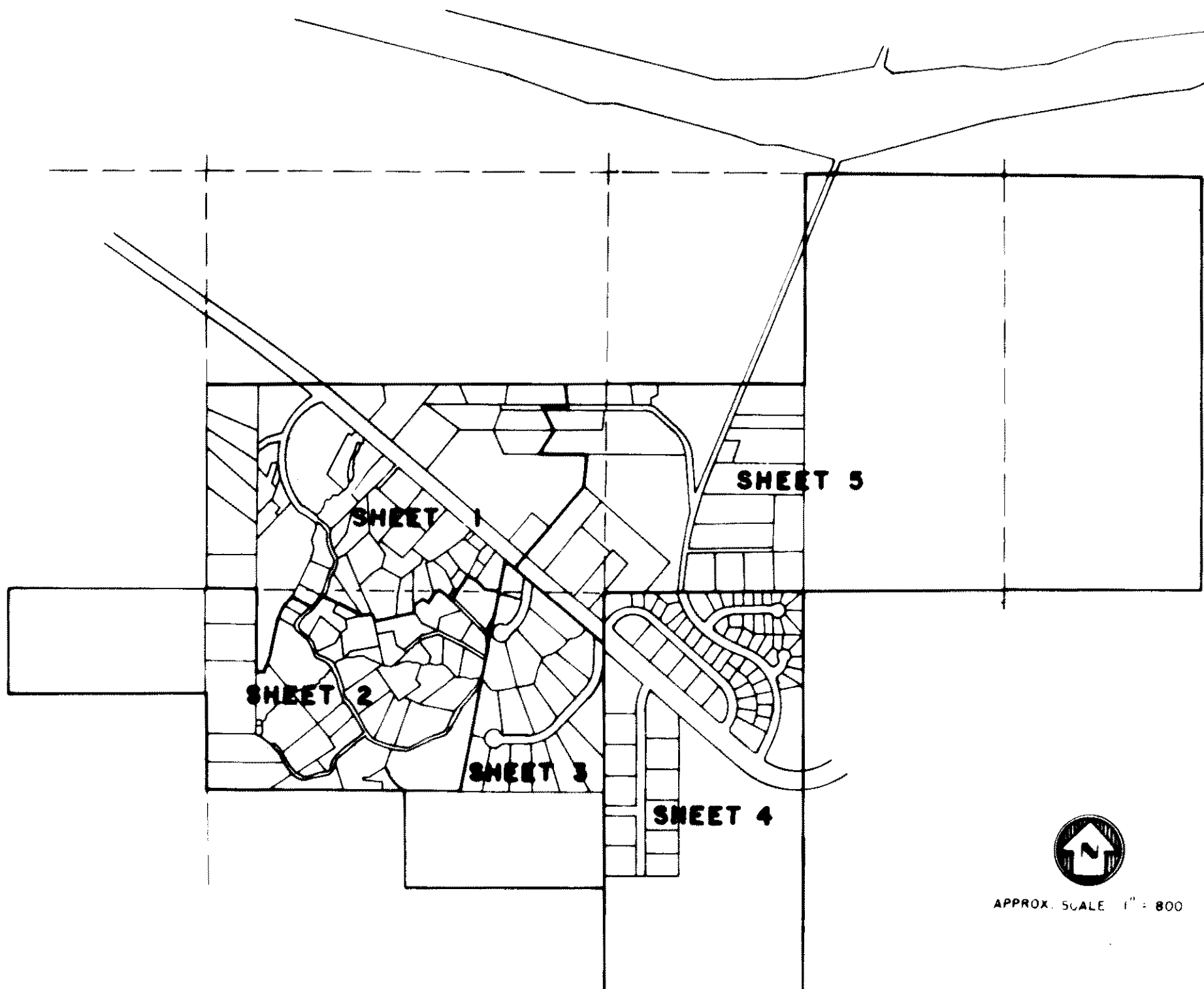

AMENDED ASSESSMENT DIAGRAM - JUNE 1985

AMENDED ASSESSMENT DIAGRAM, HILTON CREEK SEWER ASSESSMENT DISTRICT NO. 1, MONO COUNTY, CALIFORNIA, AMENDING ASSESSMENTS NO. 3-018 1-056 1-055

THIS AMENDS THE ASSESSMENT DIAGRAM FOR HILTON CREEK SEWER ASSESSMENT DISTRICT NO. 1, MONO COUNTY, CALIFORNIA, PRIOR RECORDED THE 26th DAY OF April, 1978, IN BOOK 1 OF MAPS OF ASSESSMENT DISTRICTS AT PAGES 21, IN THE OFFICE OF THE COUNTY RECORDER FOR THE COUNTY OF MONO, STATE OF CALIFORNIA.

FILED IN THE OFFICE OF THE CLERK TO THE BOARD OF SUPERVISORS, THIS 17th DAY OF June, 1985.

Margie E. Poirie
CLERK TO THE BOARD OF SUPERVISORS

ASSESSMENTS NO. 3-018 1-056 1-055

HILTON CREEK SEWER ASSESSMENT DISTRICT NO. 1, WERE AMENDED BY THE BOARD OF SUPERVISORS OF THE COUNTY OF MONO TO SEGREGATE AND APPORTION SAID ASSESSMENT ON THE LOTS, PIECES AND PARCELS OF LAND AS SHOWN ON THIS DIAGRAM SAID AMENDED ASSESSMENTS WERE CONFIRMED ON THE 9 DAY OF July, 1985; SAID AMENDED ASSESSMENT DIAGRAM AND AN AMENDED ASSESSMENT ROLL WERE RECORDED IN THE OFFICE OF THE COUNTY SURVEYOR OF THE COUNTY OF MONO ON THE 12 DAY OF July, 1985. REFERENCE IS MADE TO SAID AMENDED ASSESSMENT ROLL RECORDED IN THE OFFICE OF THE COUNTY SURVEYOR FOR THE EXACT AMOUNT OF THE APPORTIONED ASSESSMENT LEVIED AGAINST EACH PARCEL OF LAND SHOWN IN THIS AMENDED ASSESSMENT DIAGRAM

Margie E. Poirie
CLERK TO THE BOARD OF SUPERVISORS

RECORDED IN THE OFFICE OF THE COUNTY SURVEYOR OF THE COUNTY OF MONO, THIS 12 DAY OF July, 1985.

Barney Boneman
COUNTY SURVEYOR

FILED THIS 1st DAY OF Oct, 1985, AT THE HOUR 11:30 O'CLOCK A M IN BOOK 2 OF MAPS OF ASSESSMENT DISTRICTS, AT PAGE 44E, IN THE OFFICE OF THE COUNTY RECORDER OF THE COUNTY OF MONO, STATE OF CALIFORNIA. #1701

Renn Nolan by So. County M. Roberts
MONO COUNTY RECORDER

LEGEND

3-005-04
1-12-01-1
A
M
ZONING
BLANK

HILTON CREEK SEWER ASSESSMENT DISTRICT NO. 1
SANITARY SEWERAGE PROJECT
MONO COUNTY, CALIFORNIA

AMENDED
ASSESSMENT DIAGRAM
AMENDS SHEETS 1, 3, _____, _____, _____, _____ OF 6
JUNE 1985

PREPARED BY
MONO COUNTY SURVEYOR
BRIDGEPORT, CALIFORNIA

SHEET 6 OF 6

A/B-2 P4-E